

CDA-2**Computer Distribution Amplifiers****FSR****Video Products Group**

**Supports up to
QXGA (2048 x
1536@60Hz)**

The CDA-2 is a computer video distribution amplifier. It takes the input signal from the video card of a computer and splits it to be used by a projector and a monitor. This unit not only splits the signal it also buffers it to ensure absolute signal integrity at the receiving device (projector or monitor). With 300 MHz of bandwidth, the CDA-2 can support up to a QXGA (2048 x 1536 @ 60Hz) computer video signal.

FEATURES:

- Compatible with LCD panels, projectors and monitors
- Two outputs
- Metal case provides superior shielding
- HD 15-pin 5 ft. male-to-male monitor cable included
- 300 MHz video bandwidth
- Individually buffered outputs
- UL and CSA approved external power supply (wall plug-in)
- ID bits passed through to monitor output (permits monitor to determine video resolution)
- Locking power connector

SPECIFICATIONS:**Video Inputs:**

Number/type	1 RGB + Sync
Connectors	15 pin HD female
Level (nominal)	Analog 0.7V p-p
Level (maximum)	2V p-p
Impedance	75 ohms
Horizontal frequency	15 kHz - 200 kHz
Vertical frequency	30 Hz - 150 Hz

Video Output:

Number/type/connector	2 RGB + Sync/HD-15 female connectors
Level (nominal)	Unity
Impedance	75 ohms

Sync:

Input/output type	Sync On Green, Composite Sync, Separate Sync (same as input)
Input level	2V to 5V
Output level	2.4V into 75 ohms
Input Impedance	4.8V into Hi-Z
Output impedance	75 ohms
Propagation delay (max)	Typical 5nS
Rise/fall time (max)	2.5nS
Polarity	Matched to input polarity

Bandwidth:

>300MHz supporting up to 2048 x 1536 @ 60Hz) QXGA

Max Rec. Cable Length:

Approximately 50' cable dependent

Power Requirements:

12 VDC @ 125 mA

Mounting:

Table top

Enclosure:

Type	Metal
Dimensions / Weight	3.6" x 2.6" x 1" / 14 oz.

FSR Inc.

244 Bergen Boulevard, Woodland Park, NJ 07424
Phone: 973.785.4347 · Fax: 973.785.4207
Web: www.fsrinc.com · E-mail: sales@fsrinc.com

LIT 1124D

ACCESSORIES:

Each CDA-2 is supplied with a five foot (male-to-male) HD 15 monitor cable, and a UL and CSA approved power supply. To prevent the marring of furniture, rubber mounting feet are also provided.

CDA-2 TYPICAL APPLICATION

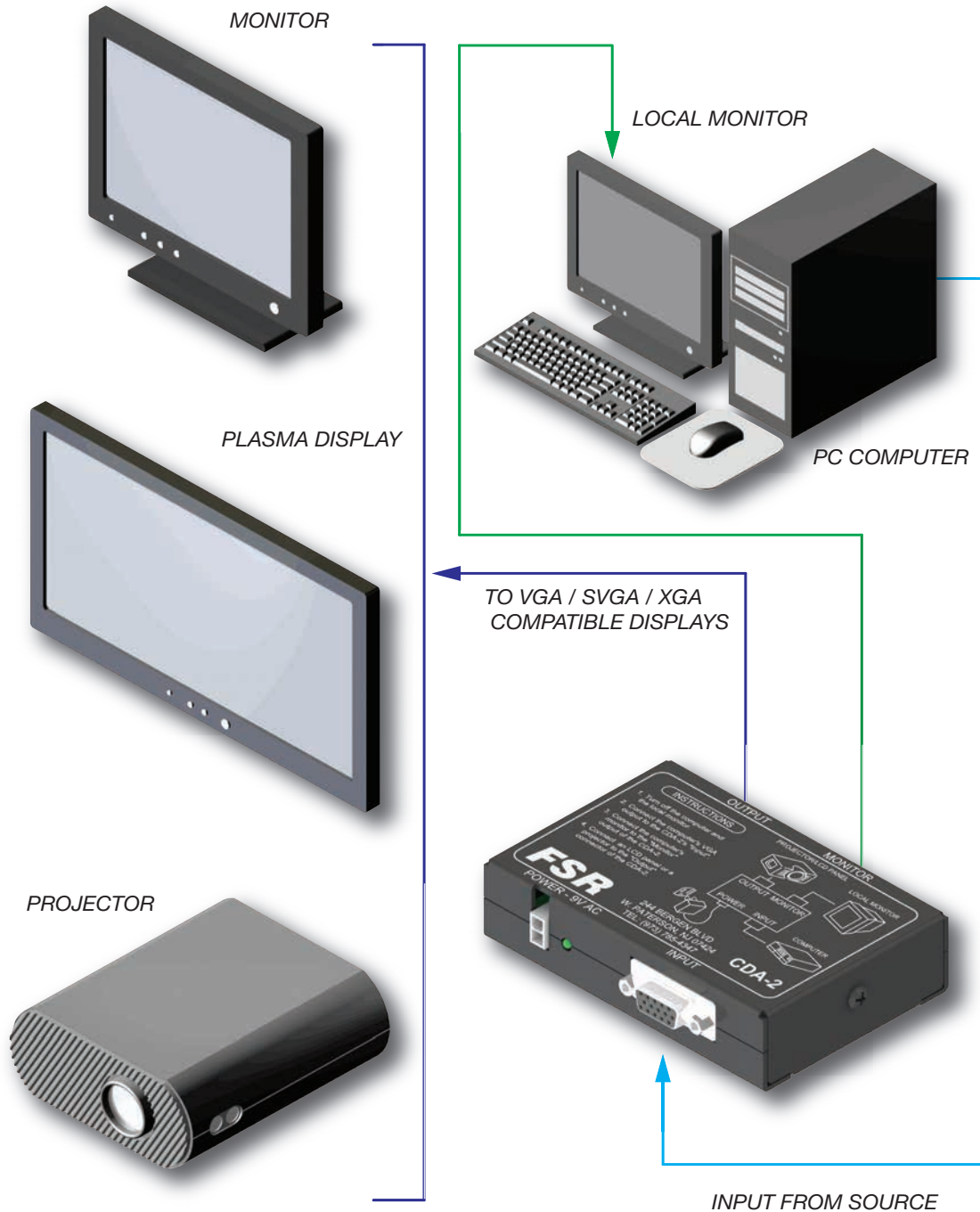

Specifications are subject to change without notice.



FSR

244 Bergen Boulevard, Woodland Park, NJ 07424
 Phone: 973.785.4347 · Fax: 973.785.4207
 Web: www.fsrinc.com · E-mail: sales@fsrinc.com